

ESCD Self Contained

REFRIGERATED SALAD TABLE WITH CURVED FRONT GLASS



ESCD67

Standard Features

- Curved front glass
- Stainless-steel work counter
- Body white finish
- Lamp with LED light
- Illuminated display area
- Automatic defrost cycle
- Digital temperature display
- Automatic condensation disposal
- Environment friendly R134a or R404A
- Additional refrigerated bottom storage

Options

- Other colors available
- Internal frame painted silver or gold
- Straight front glass available

Metal elements colors

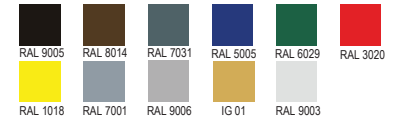

Aluminum profiles colors



Technical Drawing

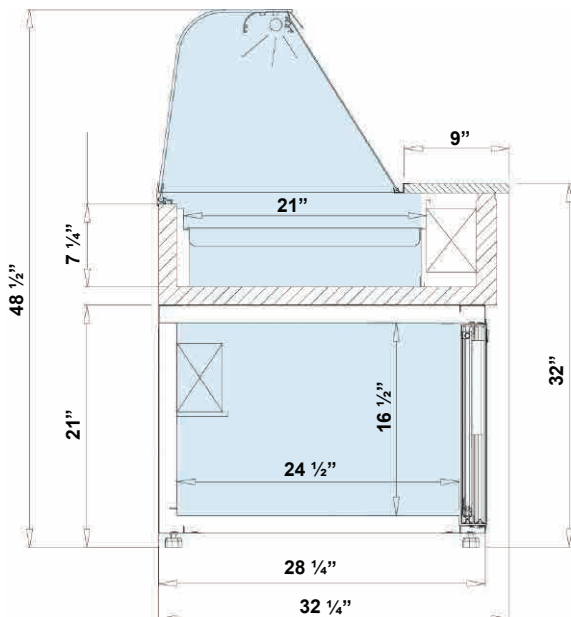

Dimensions

Model	Dimension W x D x H	Weight (lbs / kg)
ESCD39	39" x 32 1/4" x 48 1/2"	265 / 120
ESCD51	51 1/4" x 32 1/4" x 48 1/2"	298 / 135
ESCD59	59" x 32 1/4" x 48 1/2"	342 / 155
ESCD67	67" x 32 1/4" x 48 1/2"	364 / 165
ESCD75	76 3/4" x 32 1/4" x 48 1/2"	397 / 180

Voltage

- ESCD39 : 115V/ 1ph / 60 Hz / 6A, max. fuse: 15A
- ESCD51~75 : 115V/ 1ph / 60 Hz / 8A, max. fuse: 15A

* Specifications are subject to change without notice.

**All measurements are approximates.

***All equipment designed to operate in controlled environment below 75°F (+24°C) temperature and HR 55% relative humidity.